

XDL E6 XTM

PRODUCT SPECIFICATION

Adaptive Directional | Wall Wash | Fixed to 30° Tilt

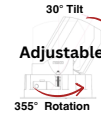
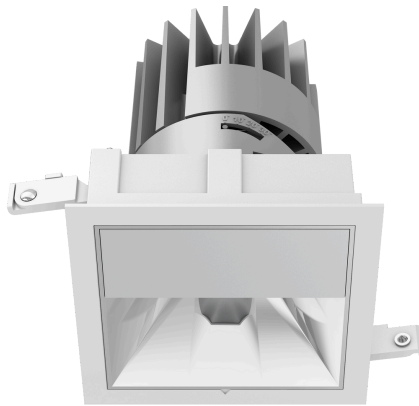

Product Features

- XDL E6 XTM Series offers exceptional and reliable performance backed by industry leading 10 year warranty*
- Utilizes Xicato XTM light source with superior 1x2 SDCM color consistency with ZERO color shifts
- Xicato's patented Corrected Cold Phosphor Technology® provides exceptional light and color performance
- World class quality of light with CRI/R9 of up to 95/90
- High performing reliable driver electronics delivering true flicker-free dimming performance
- Cutting edge dimming performance down to 0.1%** with 0-10V, DALI-2 and Xmesh wireless control
- Adaptive 2-in-1 fixture design transforms a fixed downlight to adjustable with a simple adjustment
- Complimentary Wall Wash option delivers the desired lighting accent designers seek
- Classic square or round shape with options of trimmed and trimless to compliment any design
- Flexible lighting design options with variety of light levels, beam angles, and color temperature
- Choose from various install types including retrofit, new construction, and insulated ceilings
- Xicato's Xmesh wireless connectivity enables remote control and monitor from app/dashboard
- Utilize Xicato's smart building ecosystem by adding sensors, switches, and asset tags
- Double as emergency lighting with optional battery back-up

Ordering Logic

Model - Trim/Shape/Type - Output/LED/CRI/CCT - Optics/Reflector - Housing Size - Install/Dimming - Emergency

EXAMPLE: E6-WRA-L4X9030-30DW-E6H-RX10 (XDL E6 6" White Round Adaptive Downlight, 2450Lm, Xicato XTM, 90CRI, 3000K, 36 Degree White Reflector, Retrofit Housing with XAD 0-10V)

Model	Trim	Shape	Function	Output	LED	CRI	CCT
E6	XDL E6	W White B Black T Trimless	R Round S Square A Adaptive (0° to 30°) W Wall Wash	L2 1160 Lm L3 1700 Lm L4 2465 Lm	X Xicato XTM	90 95 V9 ² 95 Vibrant	27 2700K 30 3000K 35 3500K 40 4000K
Optics	Reflector	Housing Size	Install Type	Dimming Control	Emergency Backup		
25D 25 Degree 36D 36 Degree 50D 50 Degree 36W ¹ Wall Wash	W Matte White B Matte Black S Matte Silver CB Chrome Black CS Chrome Silver	E6H 6" Housing	R Retrofit NC New Construction IC Insulated Ceiling Box ICAT IC Box Air Tight	X10 0-10V Dim to 1% XD DALI-2 Dim to 0.1% X10W 0-10V with Xmesh Dim to 0.1% XDW DALI-2 with Xmesh Dim to 0.1%	Blank No Emergency E12 Emergency 90min @ 12V ECA Emergency 90min @ 10V CA Title 20		

¹36W only available for Wall Wash and only available in Matte Silver finish
²CRI 95 Vibrant only available in 3000K

Housings can be shipped separately from base downlight. EM includes remote test switch.
*See Xicato 10 Year Limited Warranty
**Down to 1% with 0-10V dimming

Technical Specifications

LED Light Source	
LED	Xicato XTM with Corrected Cold Phosphor Technology®
CCT	2700K, 3000K, 3500K, 4000K
Delivered Lumens	See Table
CRI/R9	CRI 90: ≥90/50, CRI 95: ≥95/90, CRI 95 Vibrant: ≥95/90*
LED Color Consistency	Xicato XTM with 1x2 SDCM Color Consistency
LED Rated Life (L70)	>50,000Hrs
Optical	
Beam Angle	25°, 36°, 50°
Lens Material	Polycarbonate
UGR	TBD
Electrical	
Input Voltage	120-277V
Frequency	50/60Hz
Dimmable	Yes, 0-10V to 1%; DALI-2, Xmesh Wireless to 0.1%
Power Consumption	See Table
Efficacy	See Table
Mechanical	
Base/Housing	Integrated Aluminum Heatsink / 16-Gauge Rolled Steel
Trim Finish	Matte White, Matte Black, Trimless
Reflector Finish	White, Black, Silver, Chrome Black, Chrome Silver
Shape	Round, Square
Dimensions (H x Ø Dia)	7.48 x 6.30in (190 x 160mm)
Net Weight	4.13lb (1.875kg)
Max Ambient Temp	35° C (95° F)
Application Type	Adaptive (Adjust from Fixed at 0° to 30° Tilt), Wall Wash
Installation	Retrofit, New Construction, Insulated Ceiling
Certification and Warranty	
Certification	ETL, UL2108, FCC, CE, UKCA
Environmental	RoHS
IP Rating	IP 55 with Lens Only
Warranty	10 years Limited

*CRI 95 Vibrant only available in 3000K CCT

XTM Designer (CRI 90) Performance and Efficacy*			
Model	Output (lm)	Power (W)	Efficacy (lm/W)
L2	1160	16.7	69.5
L3**	1700	24	70.8
L4	2465	34.1	72.3

*All data based on 3000K CRI 90 36° Optics as baseline

**Estimated Value

XTM Artist (CRI 95) Performance and Efficacy*			
Model	Output (lm)	Power (W)	Efficacy (lm/W)
L2	1240	18.9	65.6
L3**	1710	24.0	65.3
L4	2235	36.8	60.7

*All data based on 3000K CRI 95 36° Optics as baseline

**Estimated Value

Lumen Conversion*	
Beam Angle	Ratio
25°	0.9
36°	1
50°	0.97
Type	Ratio
Adaptive (0° to 30° Tilt)	1
Wall Wash	0.8

*All conversion based on 3000K CRI 90/95 as baseline

Dimensional Drawings

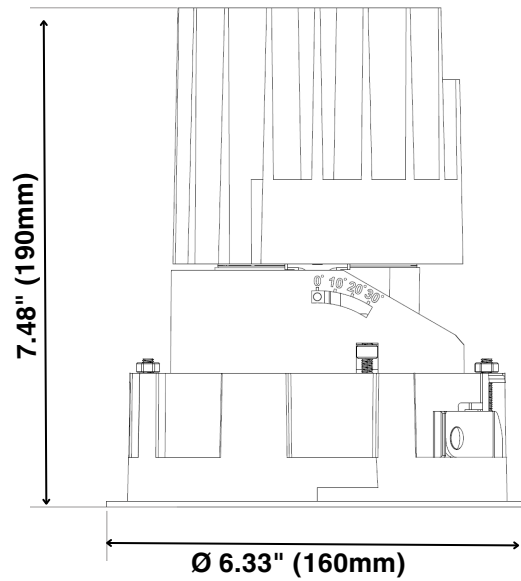

Other Dimensions

New Construction Plaster Plate

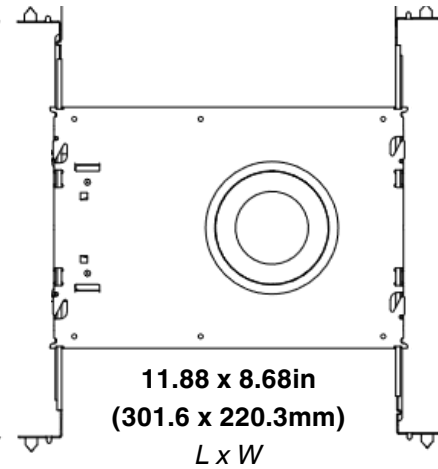

IC / ICAT / Chicago Plenum

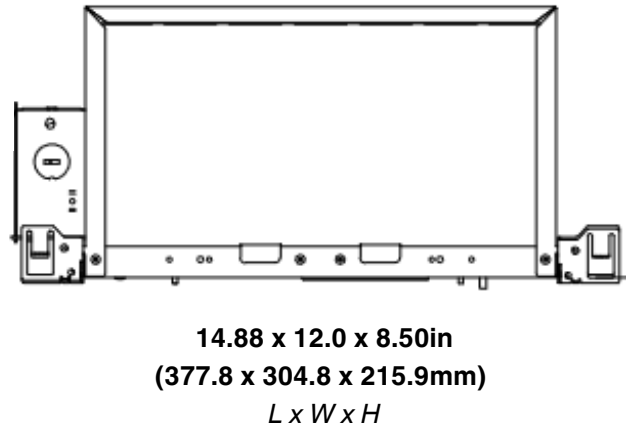

Ceiling Cutout Dimension

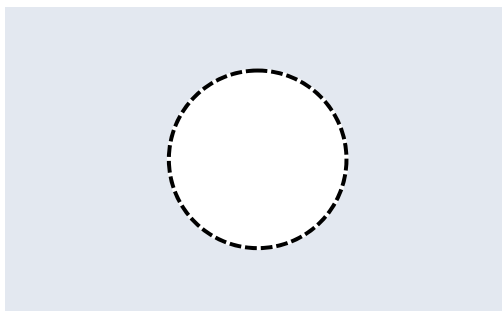

Round
Ø 5.91" (150mm)

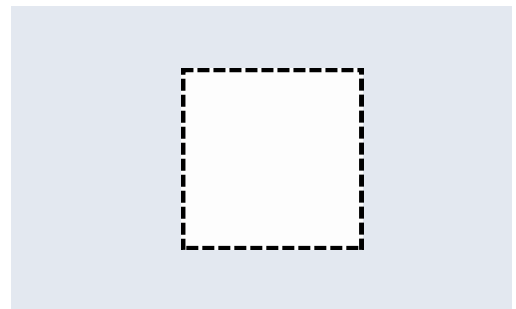

Square
5.91" x 5.91" (150 x 150mm)

Color Specification: TM-30 for Xicato XTM 3000K CRI 90

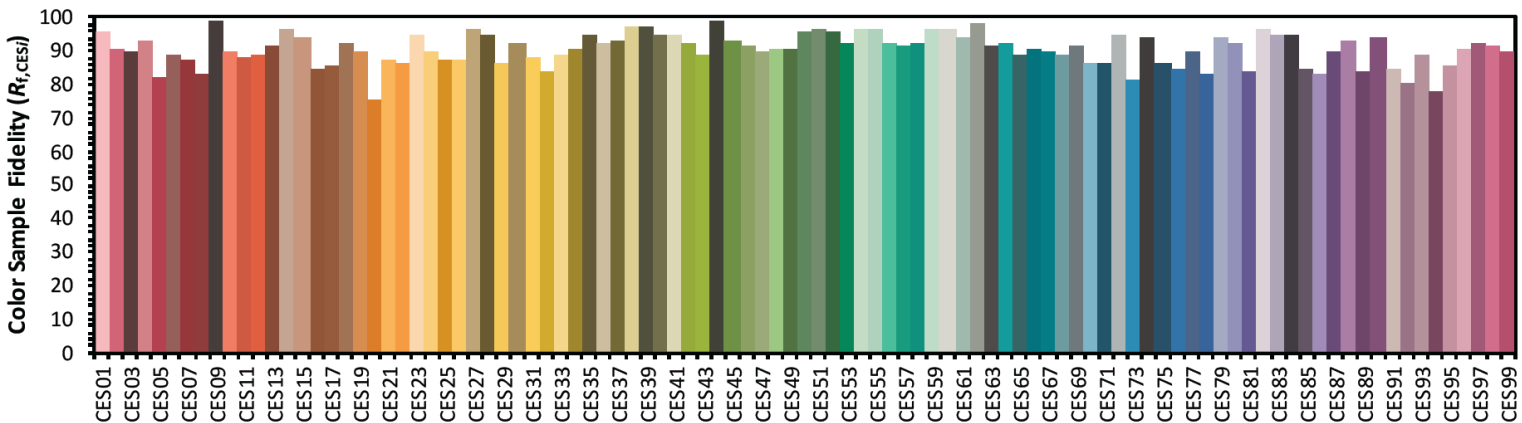
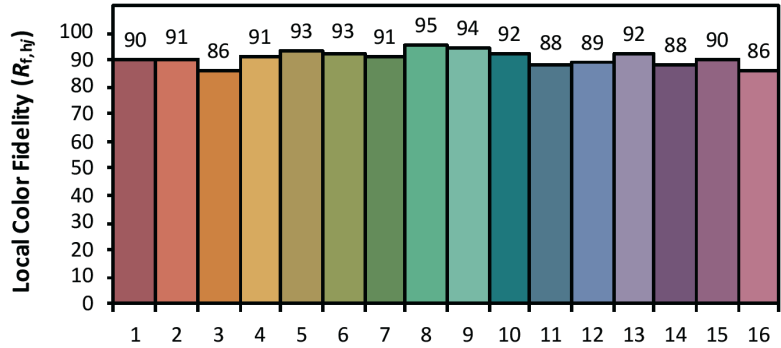
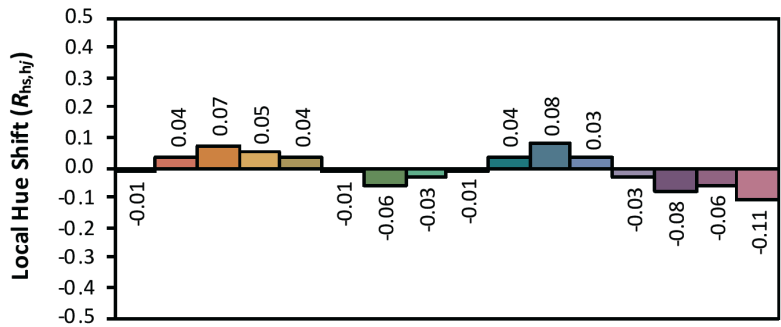
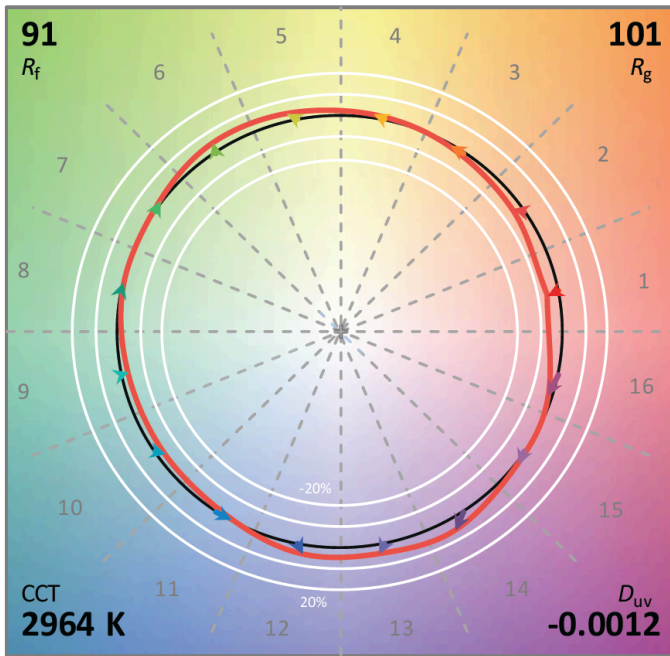
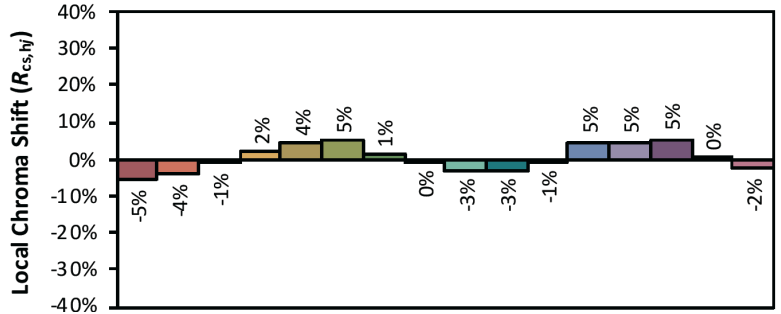
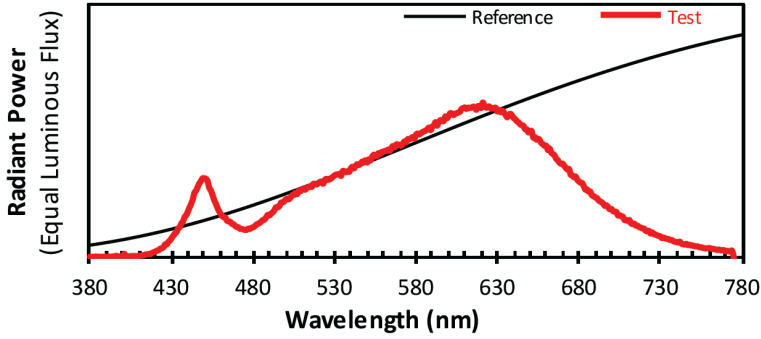

Notes: This is a recommended method for displaying ANSI/IES TM-30-18 information.

x **0.4377**
 y **0.4013**
 u' **0.2523**
 v' **0.5204**

CIE 13.3-1995	
(CRI)	
R _a	91
R _g	55

Colors are for visual orientation purposes only. Created with the IES TM-30-18 Calculator v2.0.

Color Specification: TM-30 for Xicato XTM 3000K CRI 95

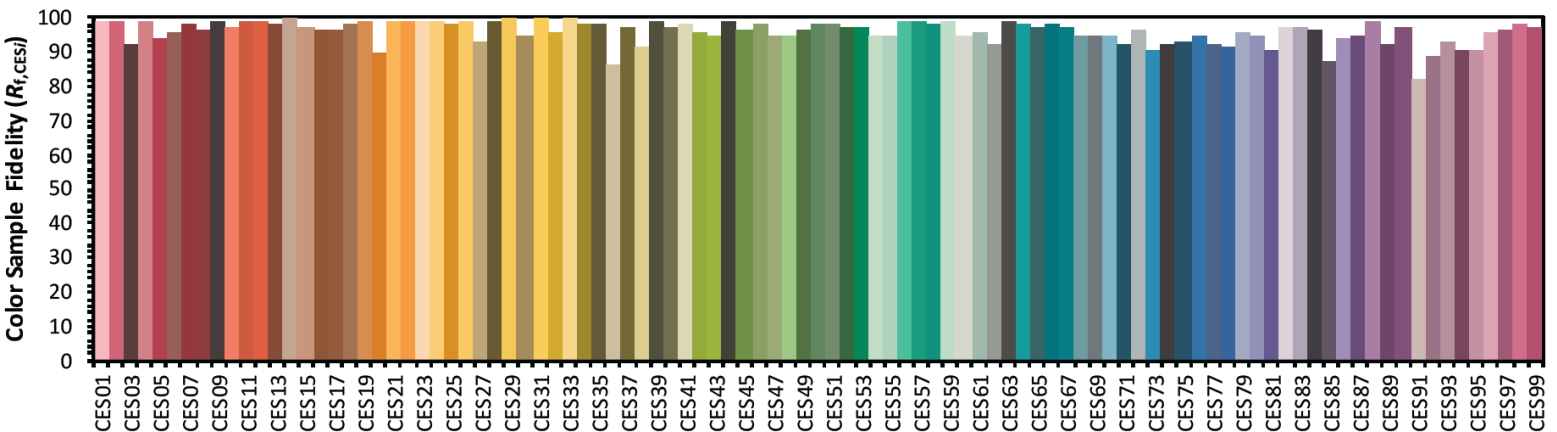
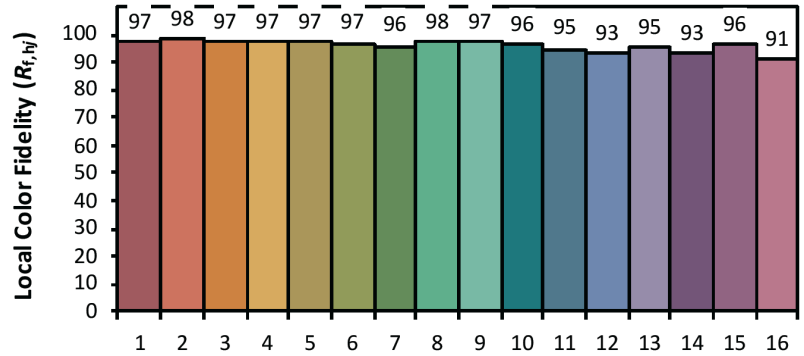
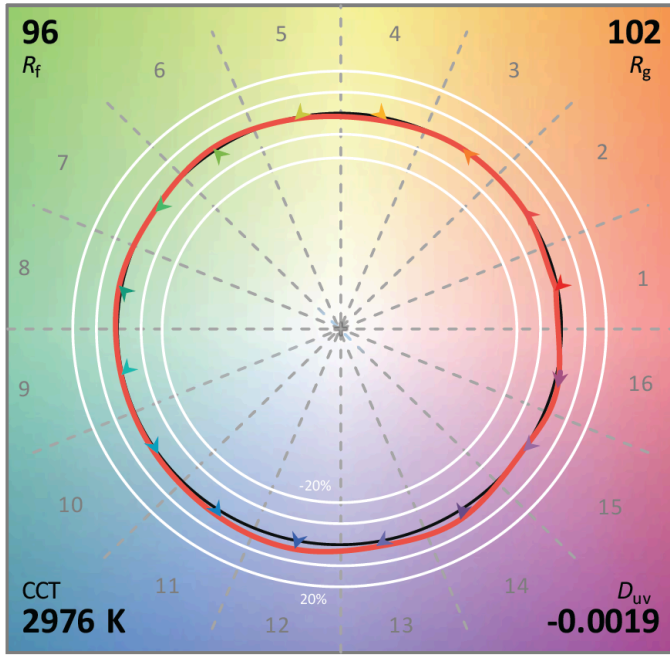
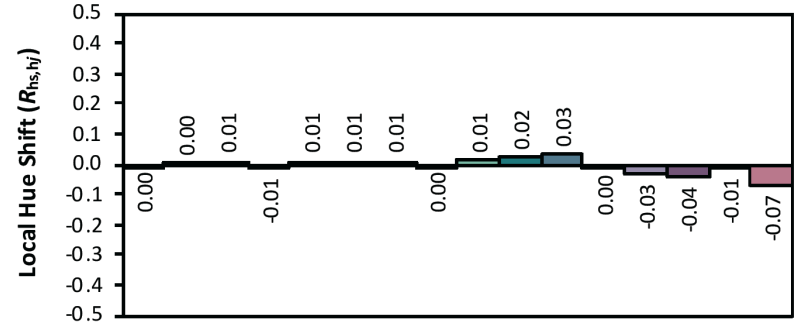
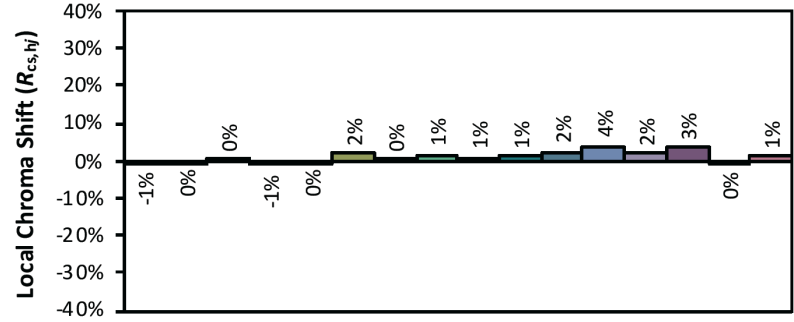
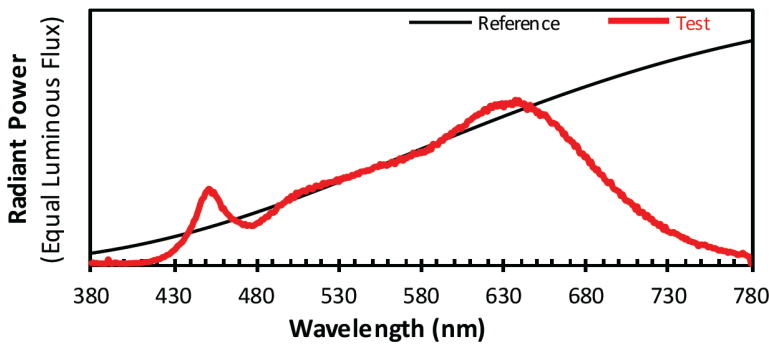

Notes: This is a recommended method for displaying ANSI/IES TM-30-18 information.

x	0.4359	CIE 13.3-1995 (CRI) R_a 98 R_g 94
y	0.3990	
u'	0.2521	
v'	0.5192	

Color Specification: TM-30 for Xicato XTM 3000K CRI 95 Vibrant

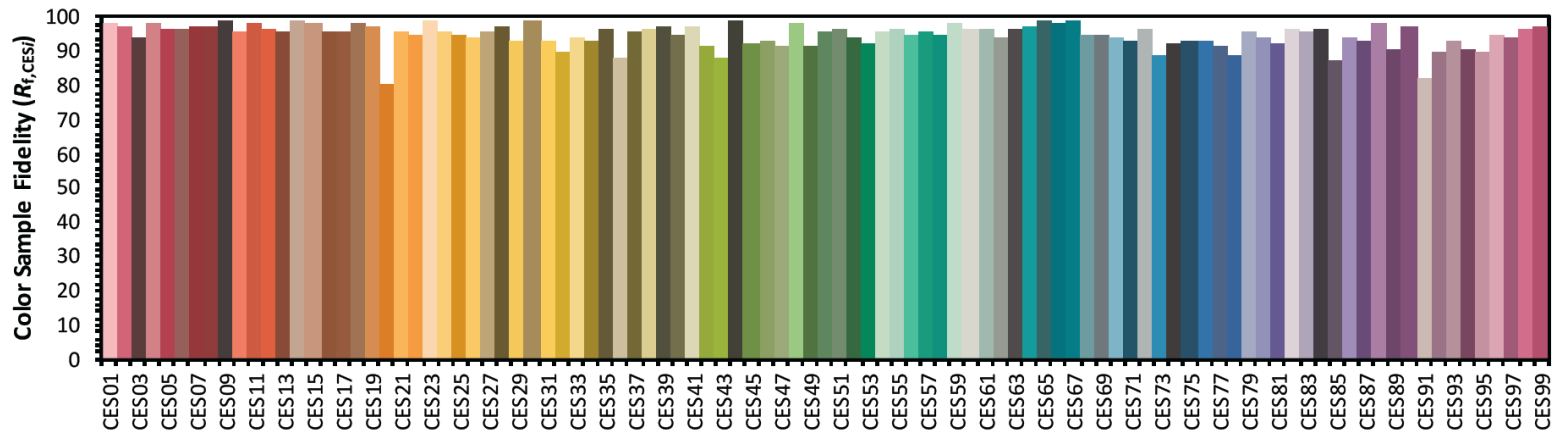
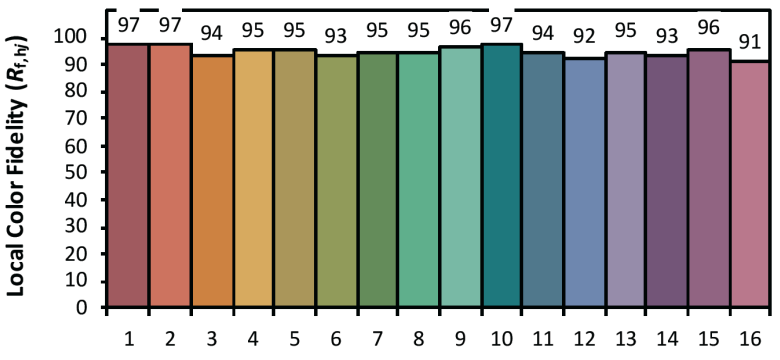
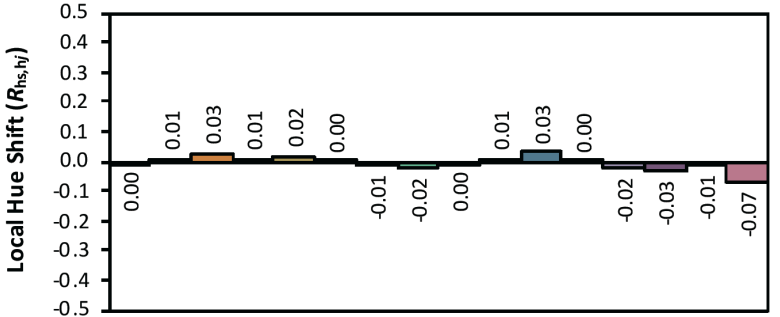
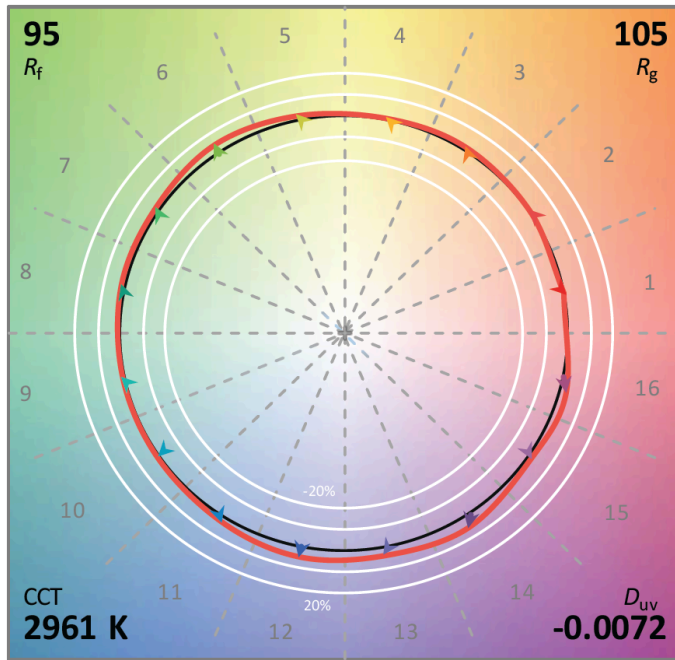
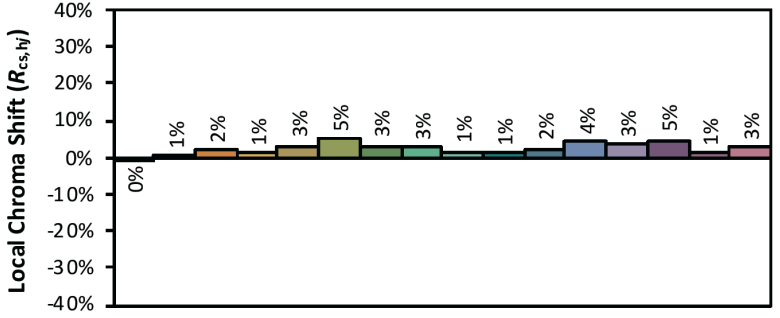
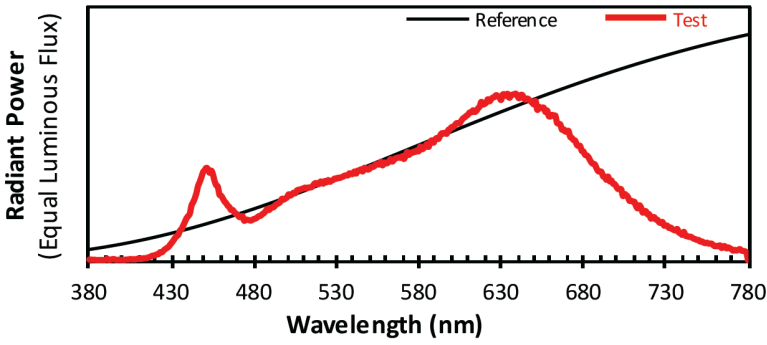

Notes: This is a recommended method for displaying ANSI/IES TM-30-18 information.

x **0.4293**
 y **0.3840**
 u' **0.2545**
 v' **0.5120**

CIE 13.3-1995	
(CRI)	
R _a	96
R ₉	98

Colors are for visual orientation purposes only. Created with the IES TM-30-18 Calculator v2.0.